



CORGAN 

A4LE Learning SCAPES 2025 PHOENIX

# **Jumpstart to Success:** Alternative Pathways in Education Through a PK-16 Approach

AIA #: SEM-211

OCTOBER 30<sup>TH</sup>, 2025



# Introductions



**Erin Ortwein**  
Senior Project Manager – Vice President  
Corgan



**Julia Hiatt**  
Interior Designer – Associate  
Corgan



The purpose  
of education  
is to prepare  
students  
for their  
future





Jumpstart to Success: Alternative Pathways in Education Through a PK-16 Approach

Immersion

The transition from home to school during early childhood introduces students to a new environment brimming with challenging experiences and opportunities to explore, connect, and grow.

Identity

As a learner develops their capabilities and interests, a passion for independence and exploration grows. The ability to uniquely impact their surroundings and make meaningful connections strengthens and molds their identity.

Purpose

Emerging adults are shaped by their experiences, passions and a developing sense of purpose. The jump into the "real-world" is a significant one that provides both opportunity and stress.

Primary



What will I discover?

Secondary



How can I make my mark?

Higher Education and Workforce



Do I have what it takes?



# *Supporting Development: Bridging Transitions*

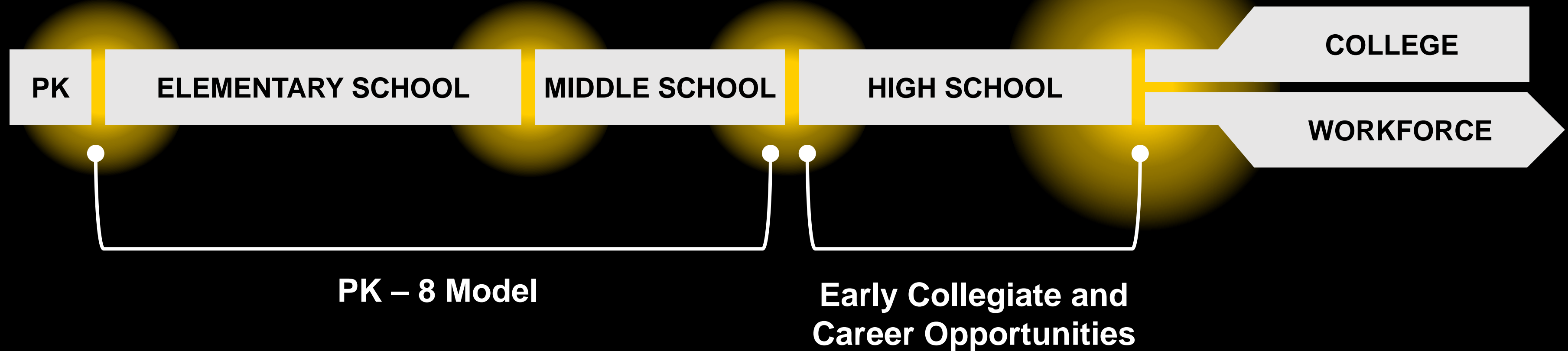



# Pathways: Connecting Students to Opportunity for Success

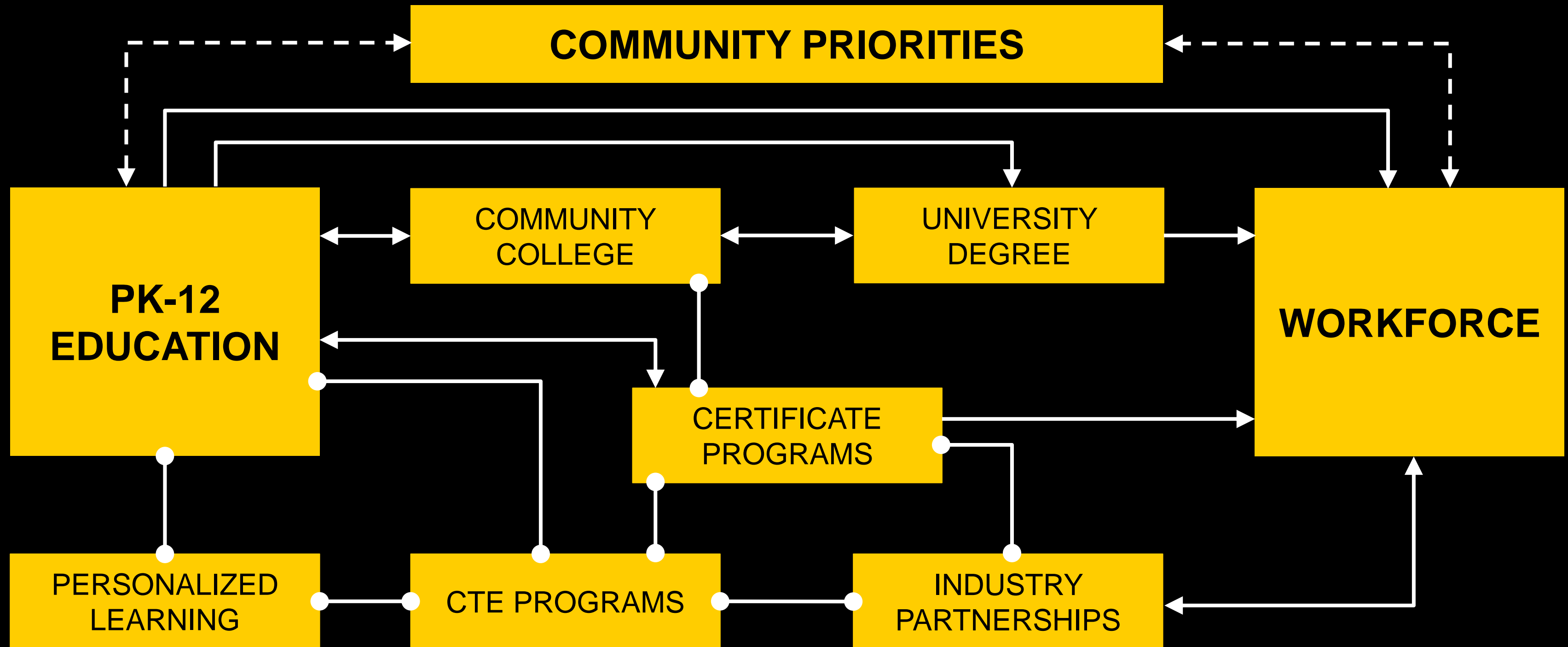



Jumpstart to Success: Alternative Pathways in Education Through a PK-16 Approach

# Impactful Learning Experiences to Spark Interests and Nurture Passions





Jumpstart to Success: Alternative Pathways in Education Through a PK-16 Approach

# Jumpstarting Success Across the PK-16 Journey

**Marana USD Dove Mountain CSTEM PK-8**



PK-8 school with a focus on hands-on STEM education

**Tyler Early College High School**



ECHS program in a dedicated high school campus

**AmTech Career Academy**

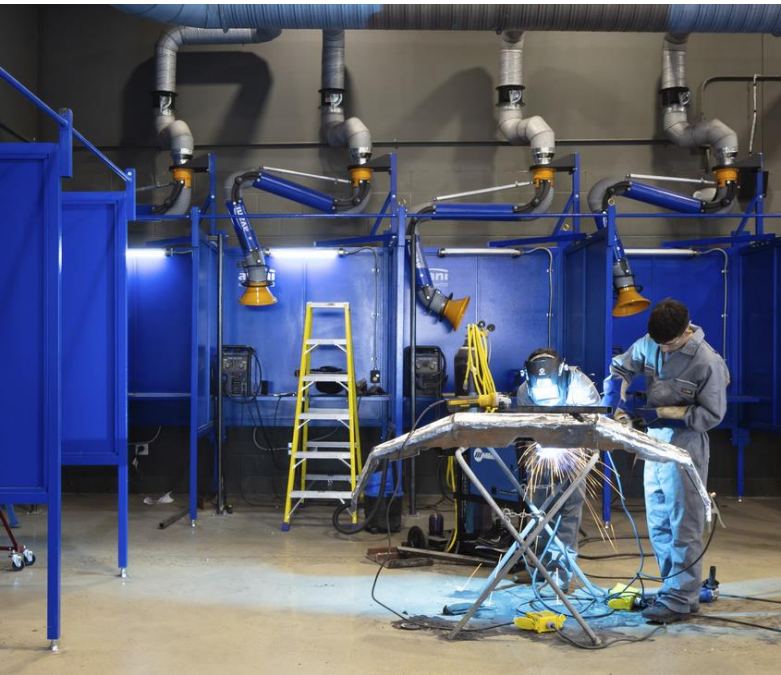

CTE facility supporting hands-on learning for 36 career pathways

**Dallas College – Early College High School**



ECHS program in a shared building on a collegiate campus



**Dove Mountain  
CSTEM K-8  
School, Marana  
USD**





Jumpstart to Success: Alternative Pathways in Education Through a PK-16 Approach

# Early Exploration and Opportunity for Growth

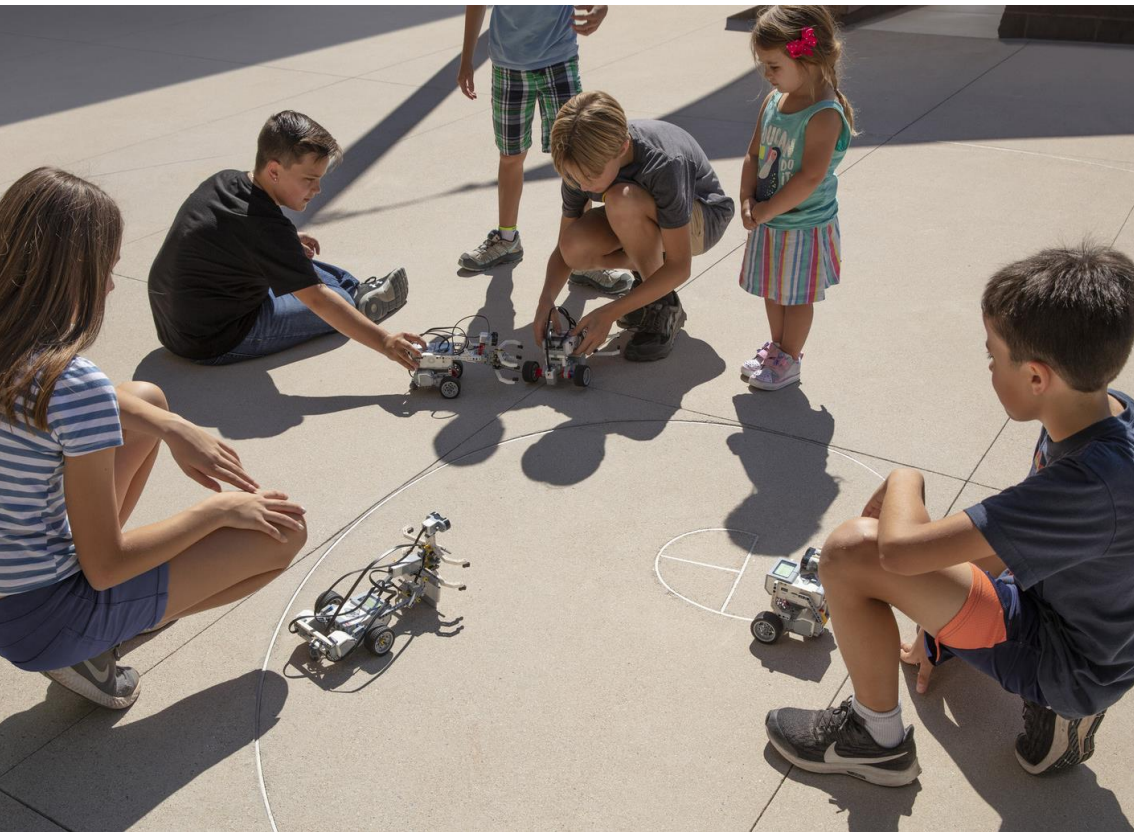



Jumpstart to Success: Alternative Pathways in Education Through a PK-16 Approach

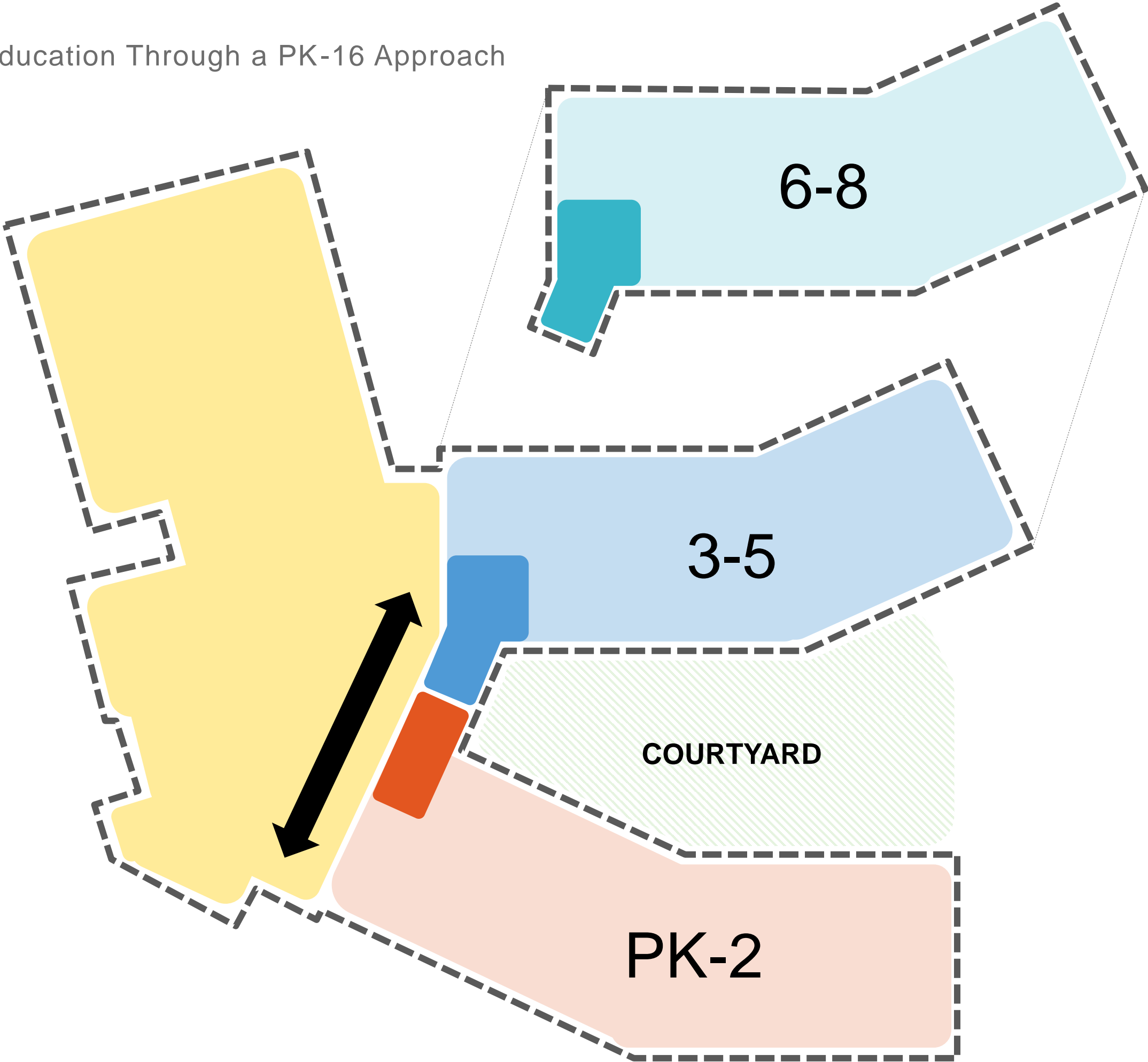



# The Learning Pathway



Flexible Classroom



Adaptable Learning



AR/VR Labs



Makerspace



IDEATION  
BEGINS

COLLABORATION

IDEAS DEVELOPED  
THROUGH AR/VR

IDEAS ARE  
BUILT

IDEAS ARE  
TESTED



Jumpstart to Success: Alternative Pathways in Education Through a PK-16 Approach

*Innovative Learning at Every Age:*  
**Grades PK – 2**



- **Hands-on learning**
- **Space for project work**
- **"Grandpa's Garage"**
- **Easy connection to the outdoors**



## Jumpstart to Success: Alternative Pathways in Education Through a PK-16 Approach

### *Innovative Learning at Every Age:* **Grades 3 – 5**

- **Elevate** topics & complexity
- **Expand technology**
- Continue to support **indoor/ outdoor connection**





Jumpstart to Success: Alternative Pathways in Education Through a PK-16 Approach

*Innovative Learning at Every Age:*  
**Grades 6 – 8**

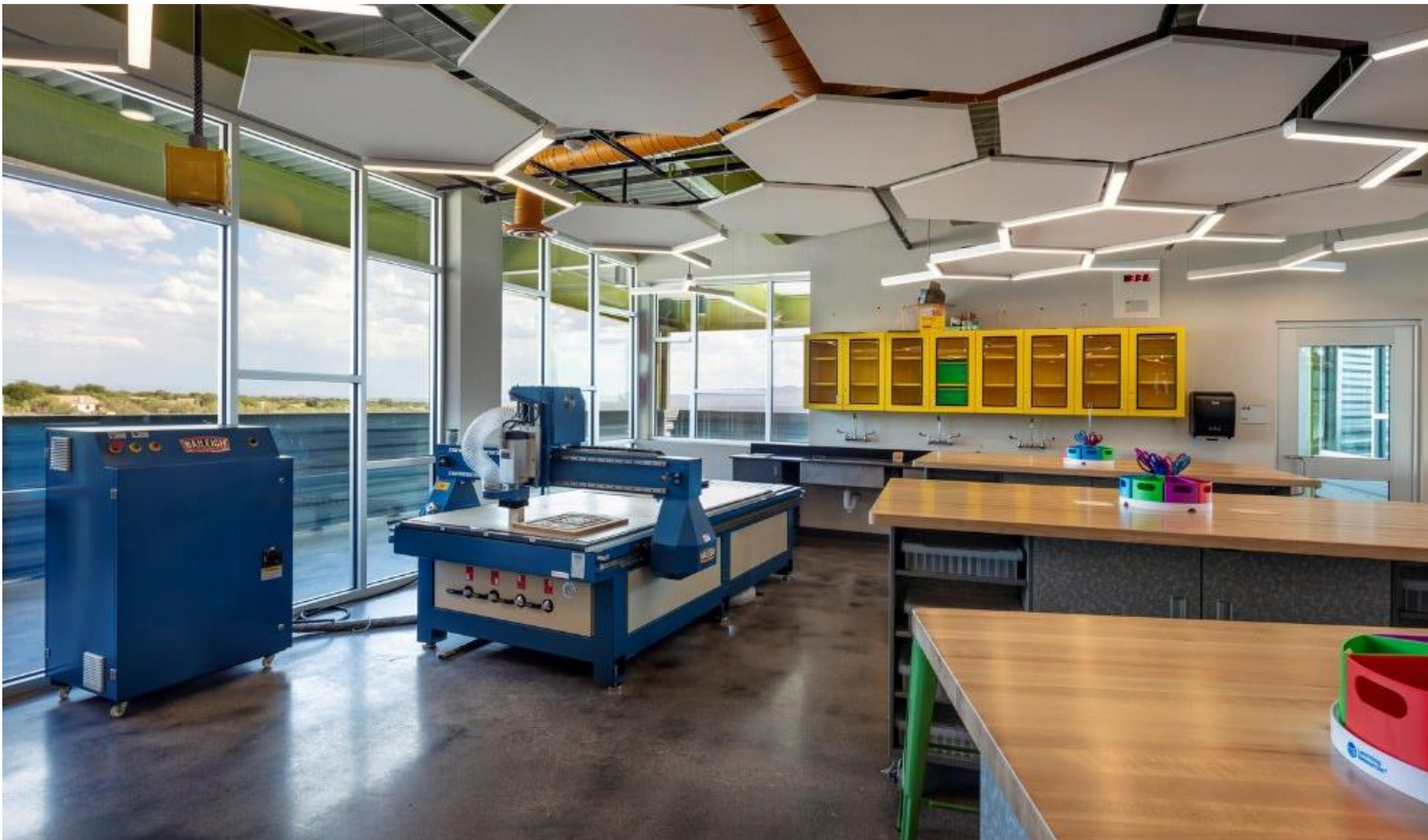

- Advance tools to align with advanced projects
- Move upstairs to provide sense of growth
- Understand pathways available at HS level



Jumpstart to Success: Alternative Pathways in Education Through a PK-16 Approach

*Innovative Learning at Every Age:*  
**Taking Learning Outside**





# Tyler Early College High School





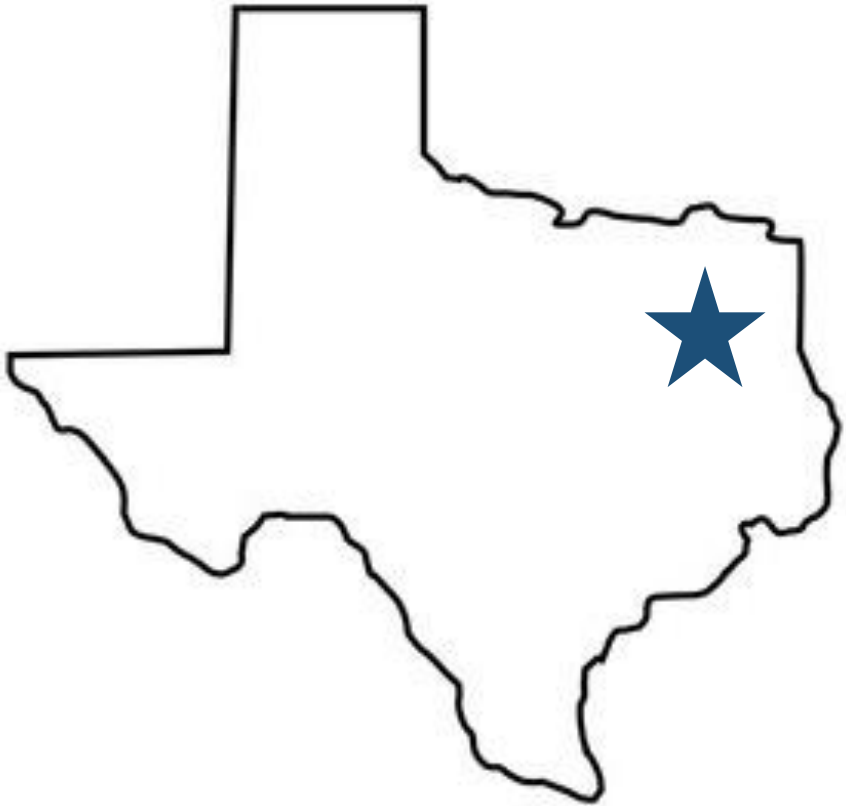
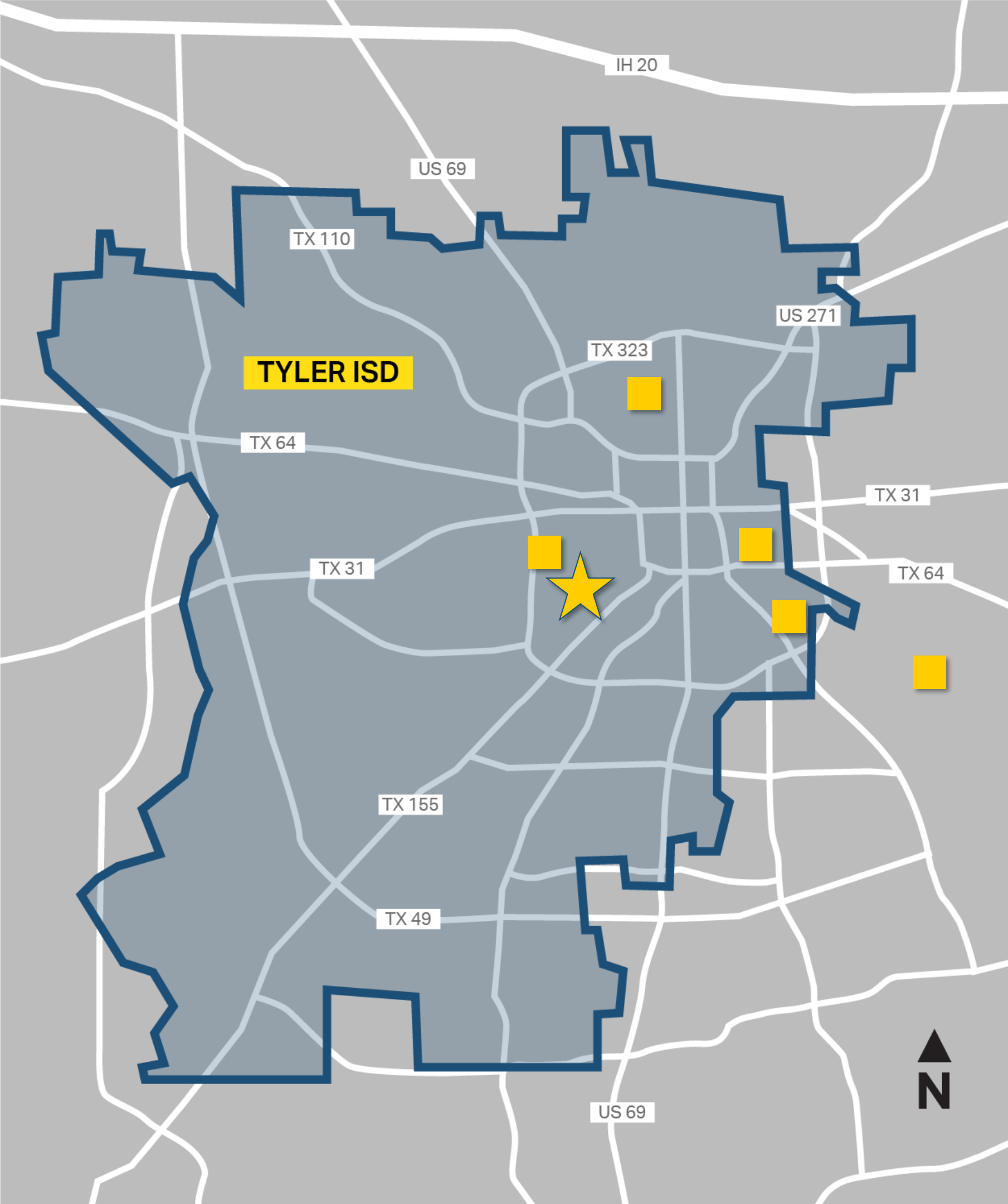

200

Approx. Square  
Miles

18,750

Students

27

Campuses

24%

English Language  
Learners

78%

Economically  
Disadvantaged



## Who Do Early College High School Programs Support?

**Early College High Schools** allow students *least likely to attend college* an opportunity to earn both a high school diploma *and* either an associate degree or at least 60 credit hours toward a baccalaureate degree

- Enroll **historically underserved students**
- Provide dual credit at **no cost** to students
- Offer **rigorous instruction** and accelerated courses
- Provide **academic and social support services**
- Provide students with highly **personalized** attention
- **Increase college readiness**
- Partner with institutions of higher education (IHEs) to **reduce barriers to college access**



[Texas Education Agency Early College High School Blueprint]



## Jumpstart to Success!

Future ECHS students learn they're accepted to the ECHS program when they're in middle school





Jumpstart to Success: Alternative Pathways in Education Through a PK-16 Approach

## Tyler ISD's Approach to an Early College Learning Experience



- Designed to be a **collegiate learning experience**
- Geared for **successful college completion**
- Successful **associate degree**
- Junior/ senior classes at **Tyler Junior College**
- **Student led**; teachers as facilitators



Jumpstart to Success: Alternative Pathways in Education Through a PK-16 Approach

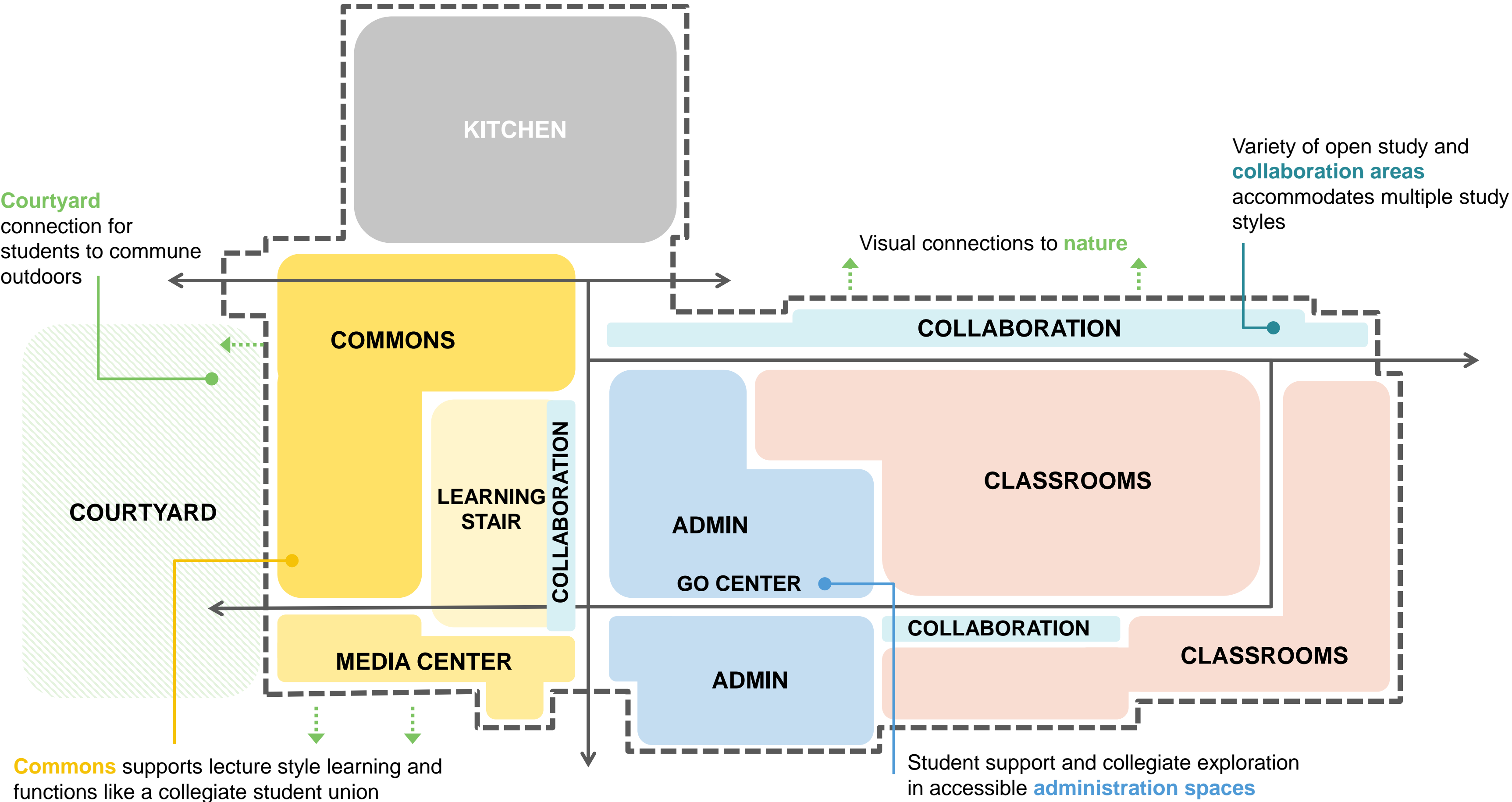



Jumpstart to Success: Alternative Pathways in Education Through a PK-16 Approach

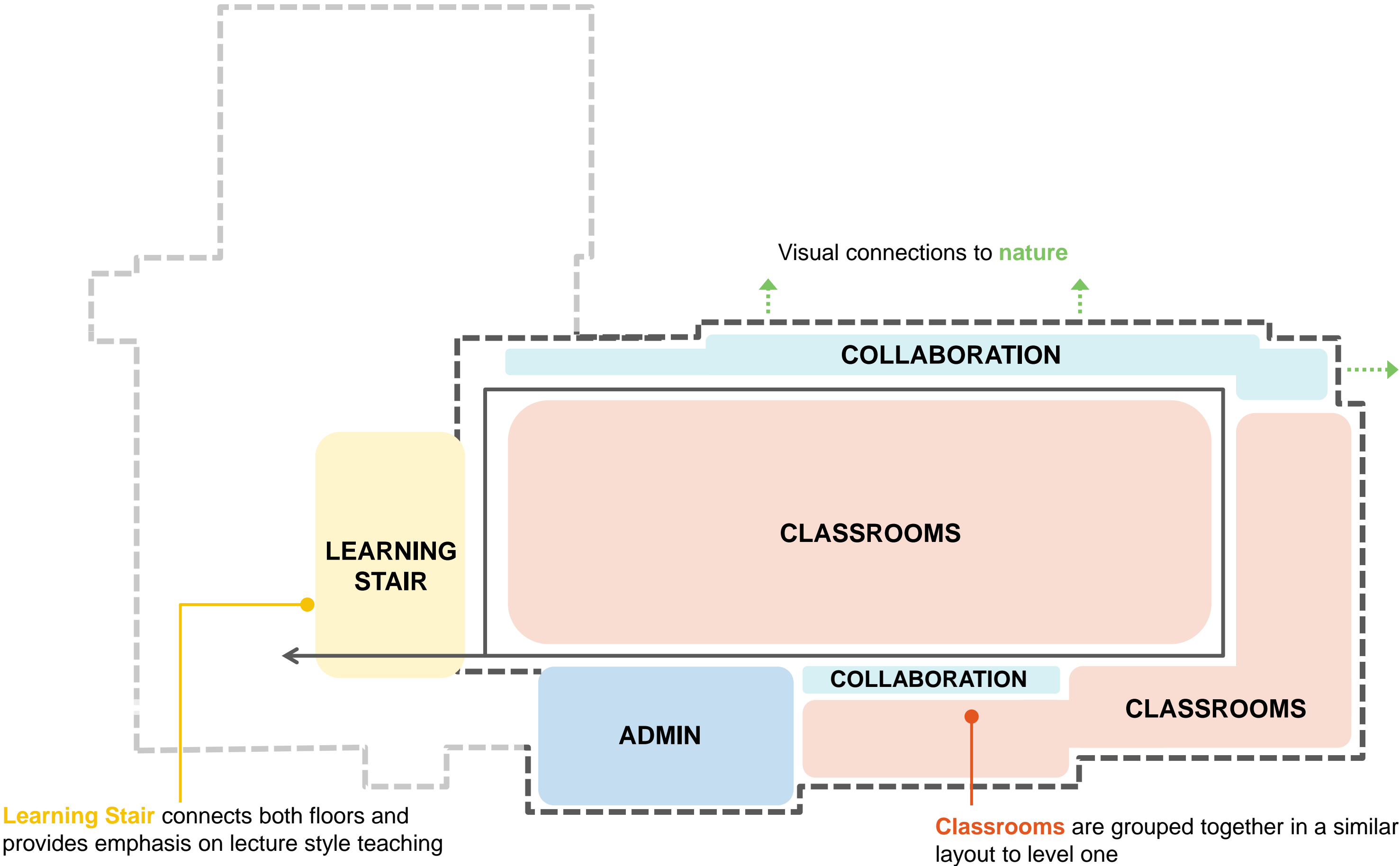







Jumpstart to Success: Alternative Pathways in Education Through a PK-16 Approach

# Collaboration Spaces in Action

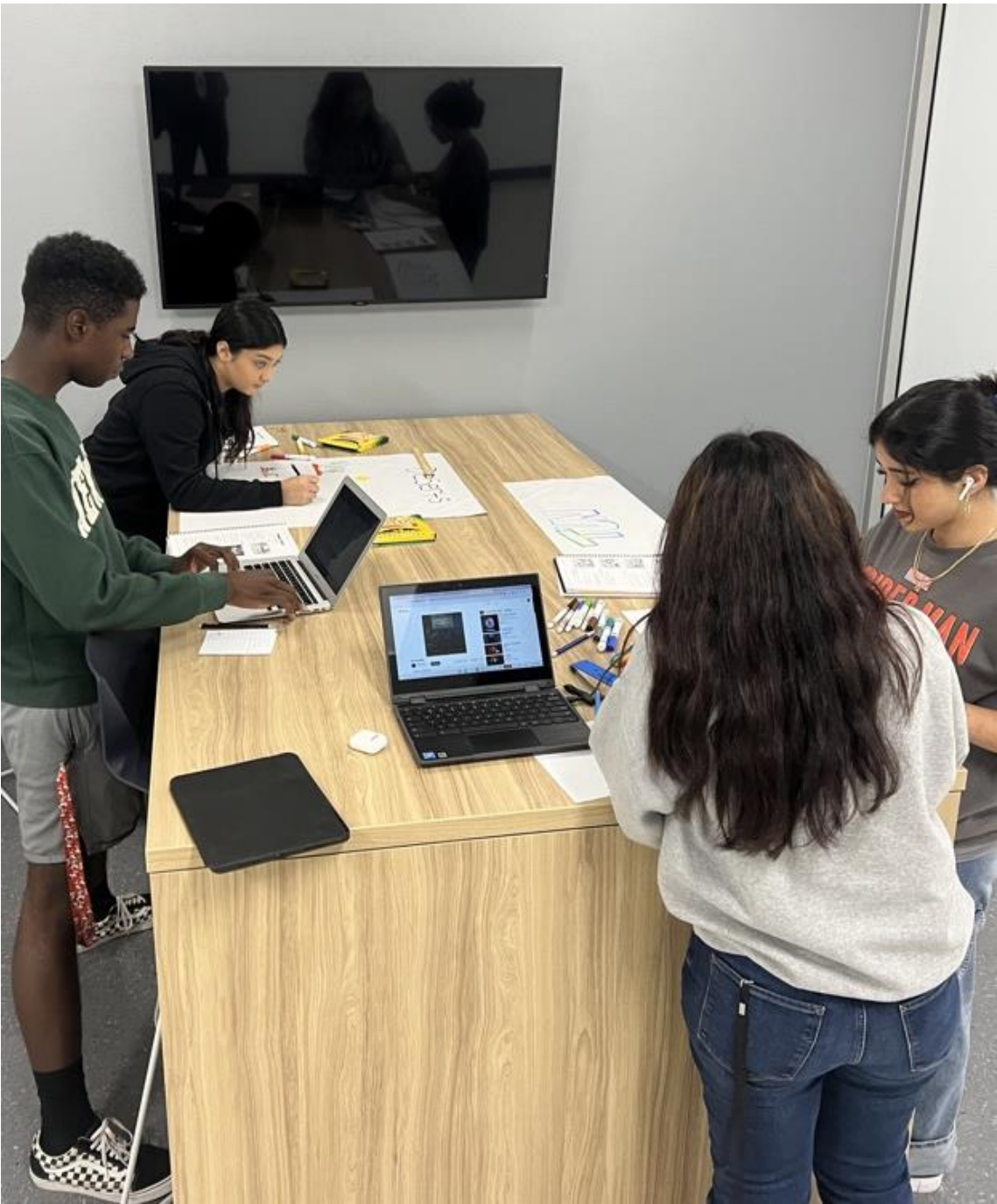
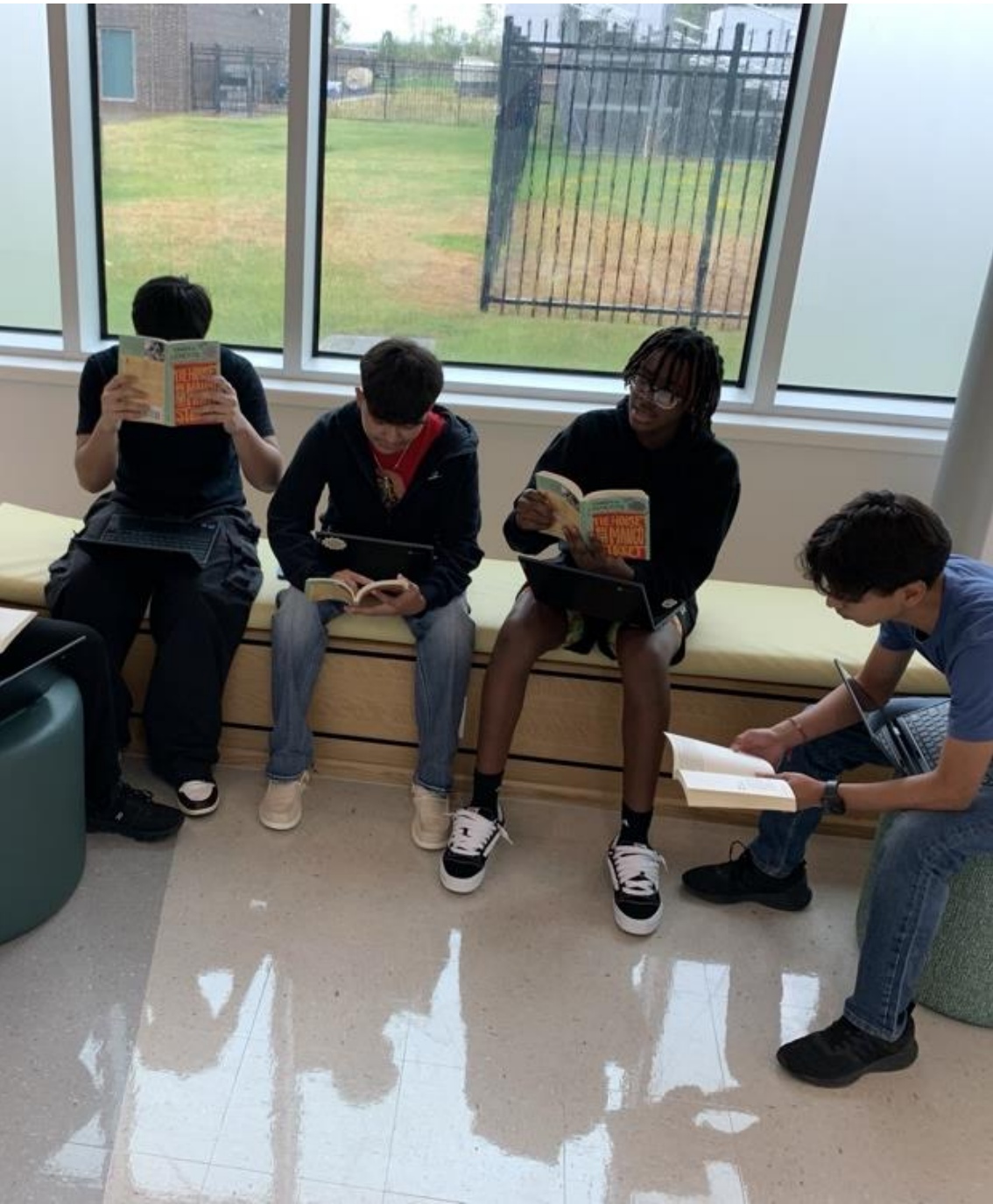



Jumpstart to Success: Alternative Pathways in Education Through a PK-16 Approach





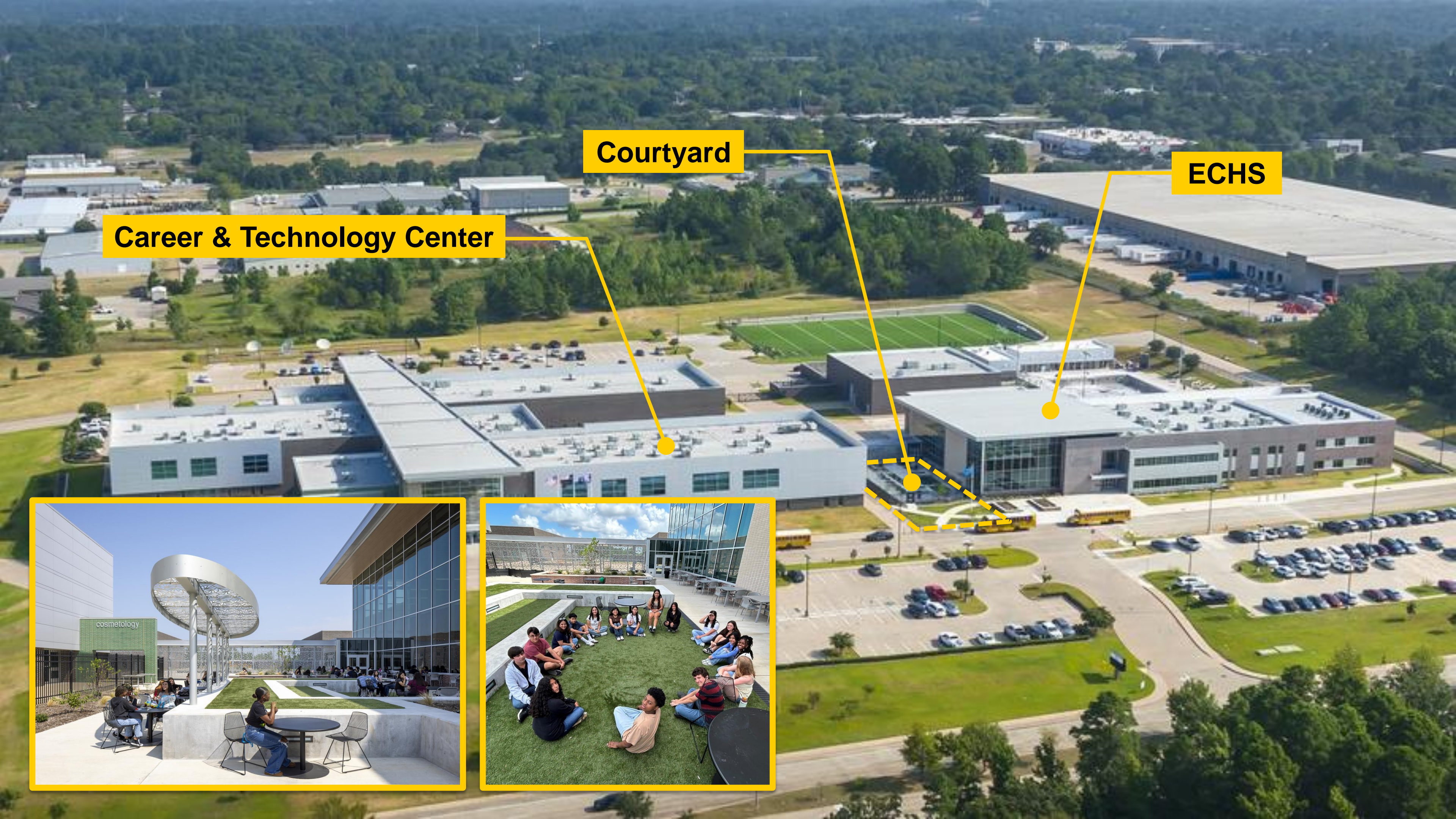

**Courtyard**

**ECHS**

**Career & Technology Center**







**Career &  
Technology Center**





# AmTech Career Academy







AmTech  
CAREER ACADEMY

WEST SIDE

- STEM / Robotics / Drone
- Architecture / Construction / Manufacturing
- Junior Achievement
- Transportation

SUCCESS  
WAY

STORM  
SHELTER



EAST SIDE

- Culinary Arts
- Public Service
- Animal Sciences
- Medical Arts
- Business / Marketing / Finance
- Information Technology
- Visual Arts & Communication



## Projected Growth in STEM Careers

According to the Department of Labor Statistics, **STEM occupations are projected to grow faster than non-STEM occupations and provide higher pay.**

**High demand for a talented STEM workforce**

Requires **equitable access** to education and opportunities

[U.S. Bureau of Labor Statistics, 2024; O'Rourke, 2021]

**+10.8%**

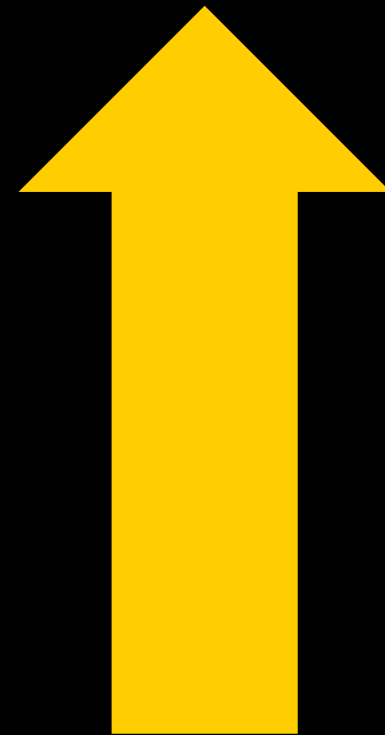

**STEM  
Careers**

**+2.3%**

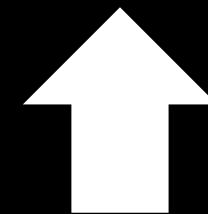

**Non-STEM  
Careers**

**STEM Offers More  
Opportunities**

*Projections for percent employment change from 2022 - 2032*

**STEM Offers  
Better Pay**

*Median annual wage data from 2023*

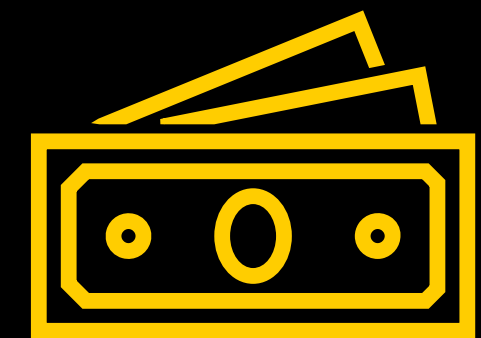

**\$101,650**  
for STEM Careers

**\$46,680**

for Non-STEM Careers



## Advancing Middle-Skill STEM Occupations



***Half of STEM occupations require less than a 4-year degree***

- Certification programs
- Industry pathways
- Skills training

[Middle Skill STEM Occupation Index; Rothwell, 2013]



Jumpstart to Success: Alternative Pathways in Education Through a PK-16 Approach

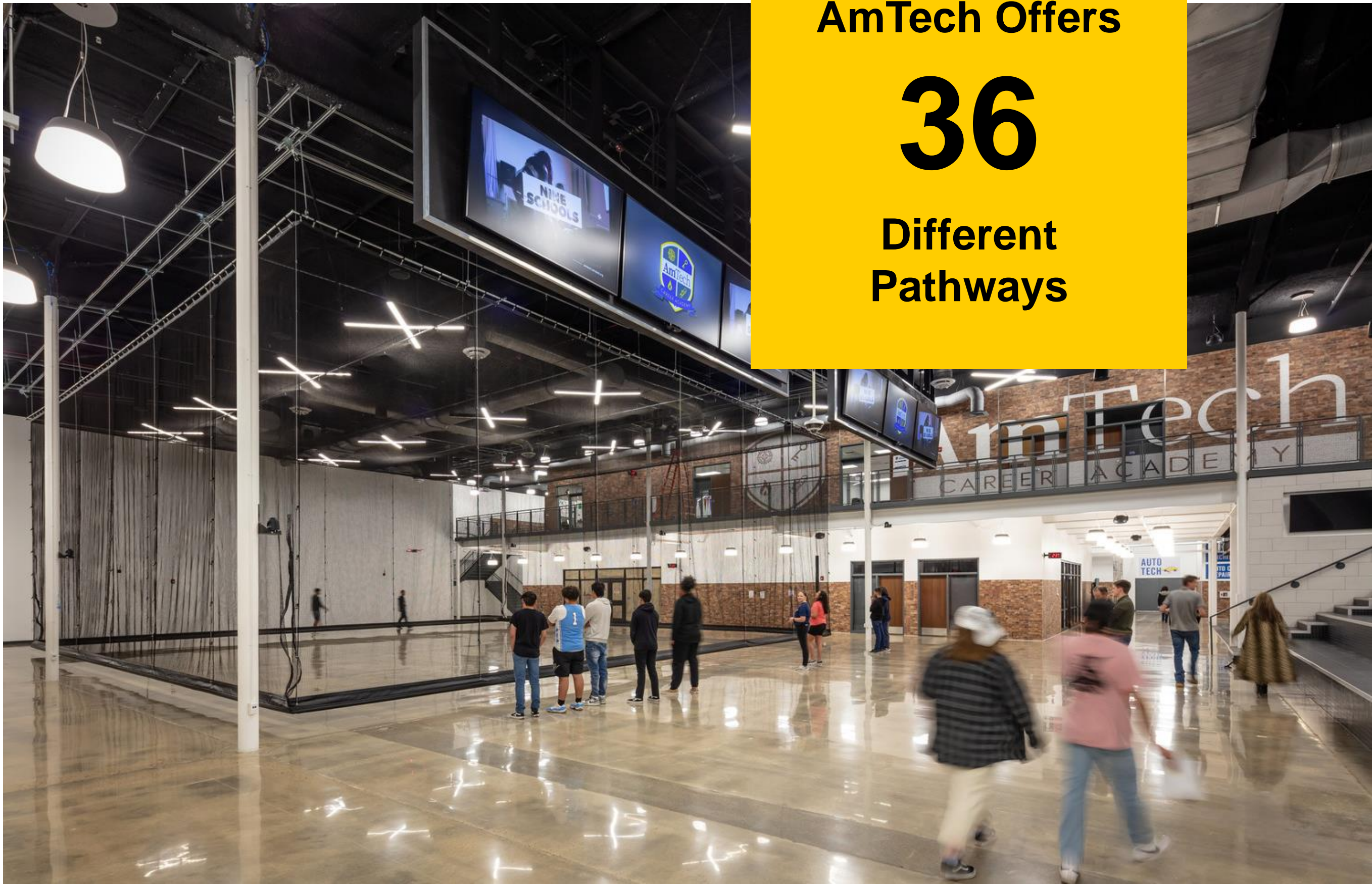

**AmTech Offers**  
**36**  
**Different Pathways**



**STEM and IT**



**Architecture, Construction,  
& Manufacturing**



**Medical Arts**



**Transportation**

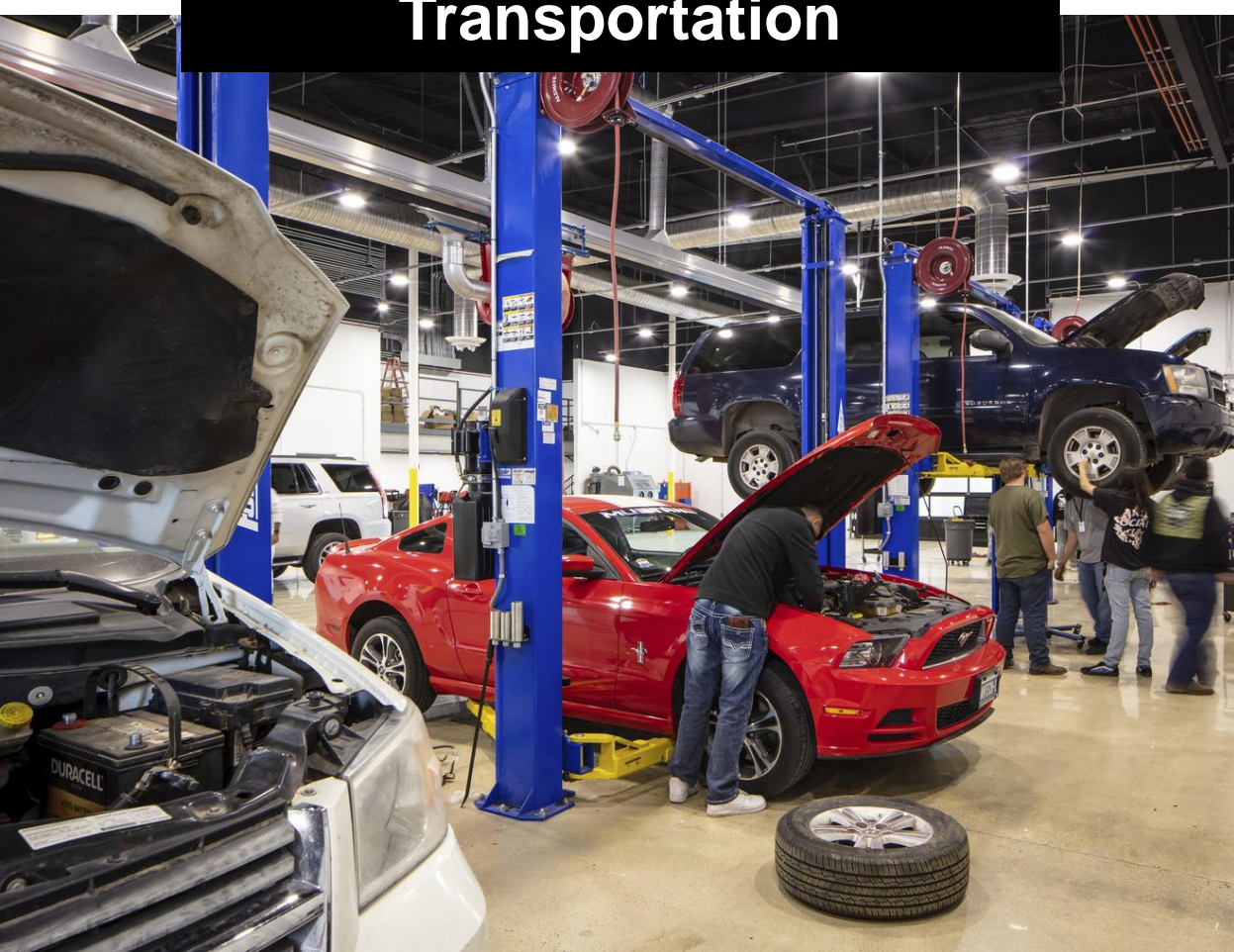

**Culinary Arts**



**Public Service**





[Educator Testimonial Video]



## Partnering for Success

- Shared focus on building both soft skills and technical skills
- Partners may provide:
  - Space build-out
  - Equipment
  - Internship opportunities
  - Skills training
- Amarillo College
  - Dual credit classes
  - College uses AmTech facilities in the evening





# Partnerships Provide Mutual Benefit

## *Impact on the Local Economy*

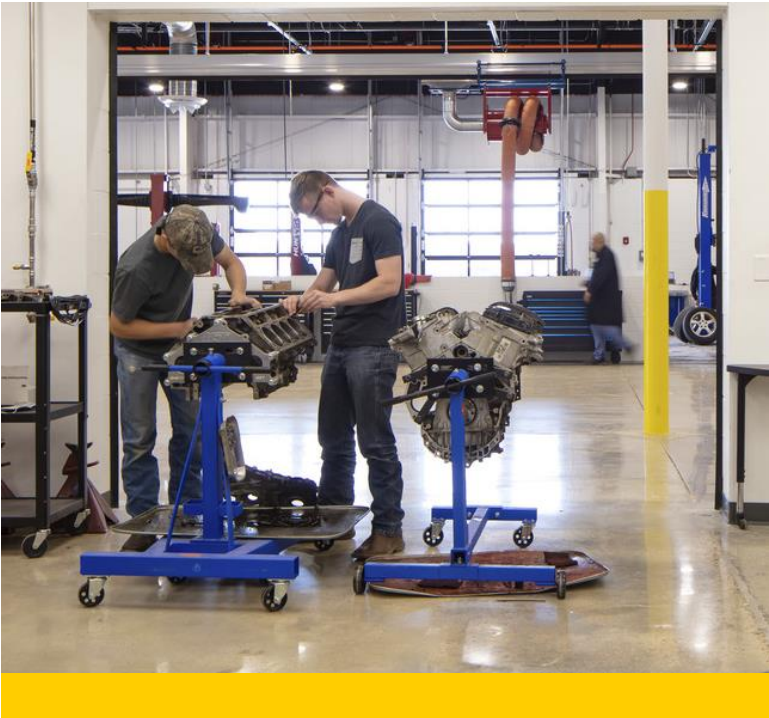

**Keeping More of the Workforce Local**



**Reduced Recruiting Costs**



**Industry Training Ground**



**Magnet for Industry Growth**



Jumpstart to Success: Alternative Pathways in Education Through a PK-16 Approach



# AmTech Career Academy

## “Signing Day”

Celebrating students who have signed on for post-graduation jobs in the Texas Panhandle





**Dallas College –  
Early College  
High School**

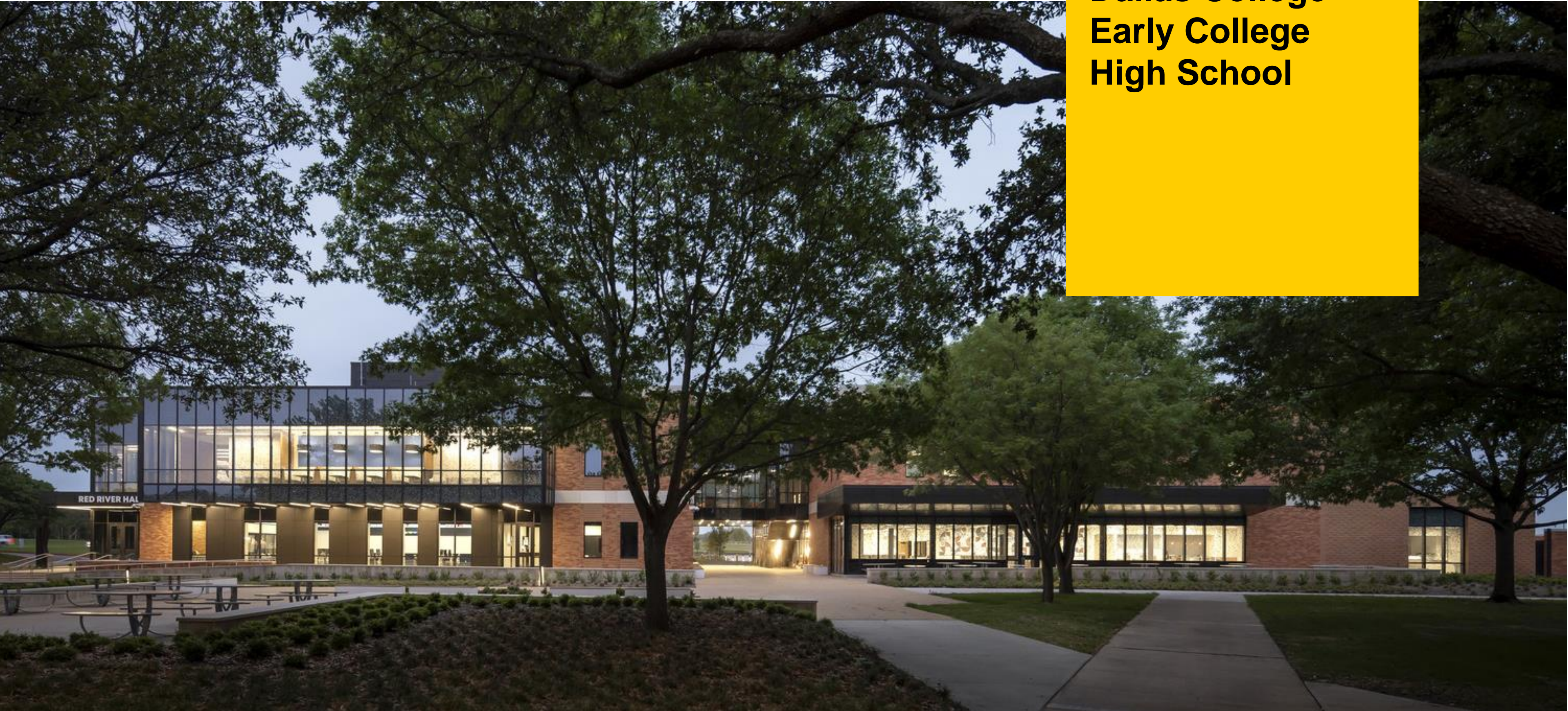



# Introduction to Dallas College

**300+**

Academic and technical degrees and certificates

**100+**

High-demand career programs and training

**15K+**

Associate Degrees, Bachelor's Degrees and Certificates awarded in 2023 - 2024

**150+**

High school partners served across all campuses

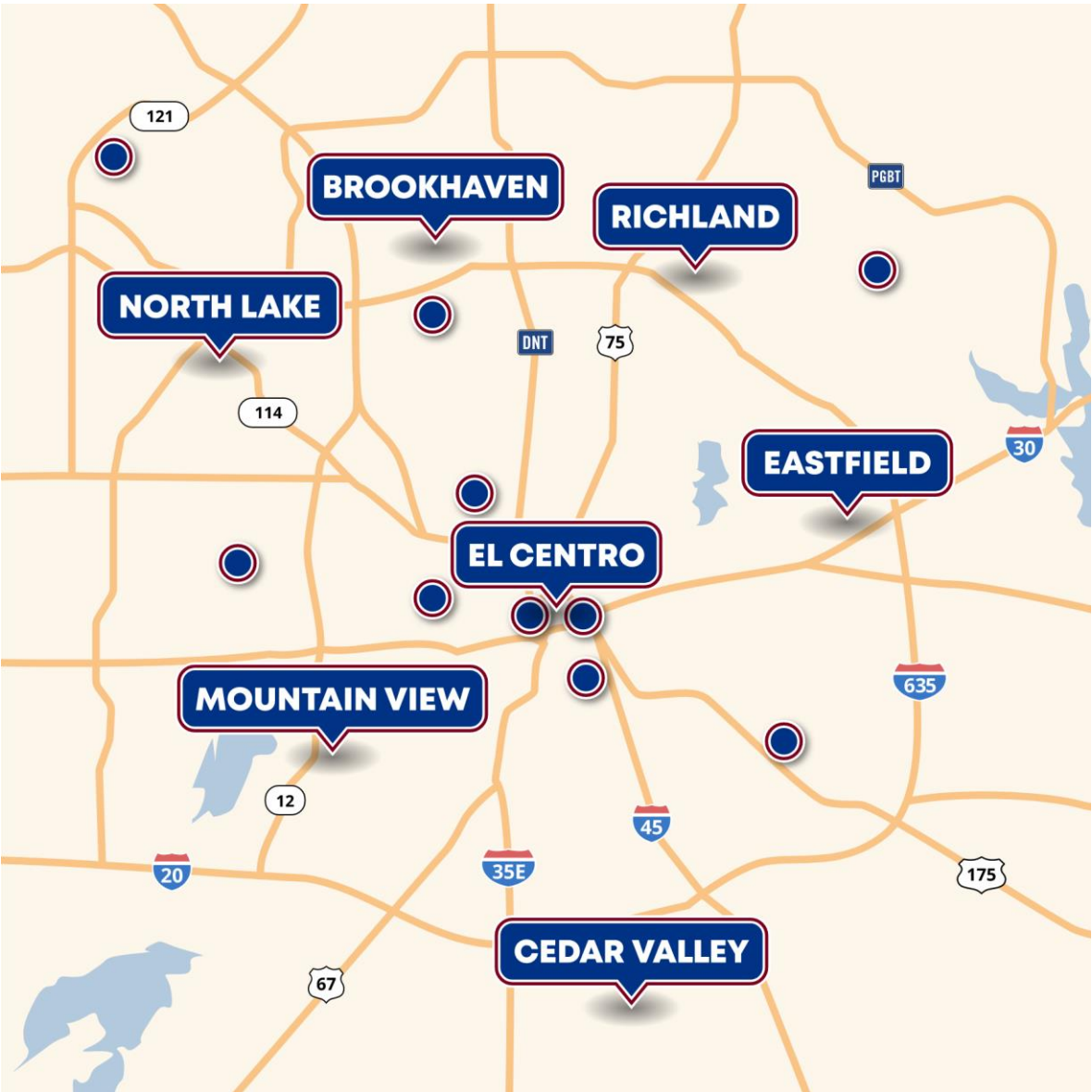

Brookhaven



Cedar Valley



Eastfield



El Centro



Mountain View



North Lake



Richland



# The Value of a Collegiate Campus Experience



Findings indicated that students who **took courses on the college campus** *reported more growth and identification with being college students* relative to those who took dual credit courses at their high school campus

[Duncheon, 2020]



# ***An Integrated Collegiate Experience***

- Red River Hall is **embedded within the campus**
- ECHS students and DC students **share a space**
- Building **amenities make Red River Hall a destination** on campus for all students

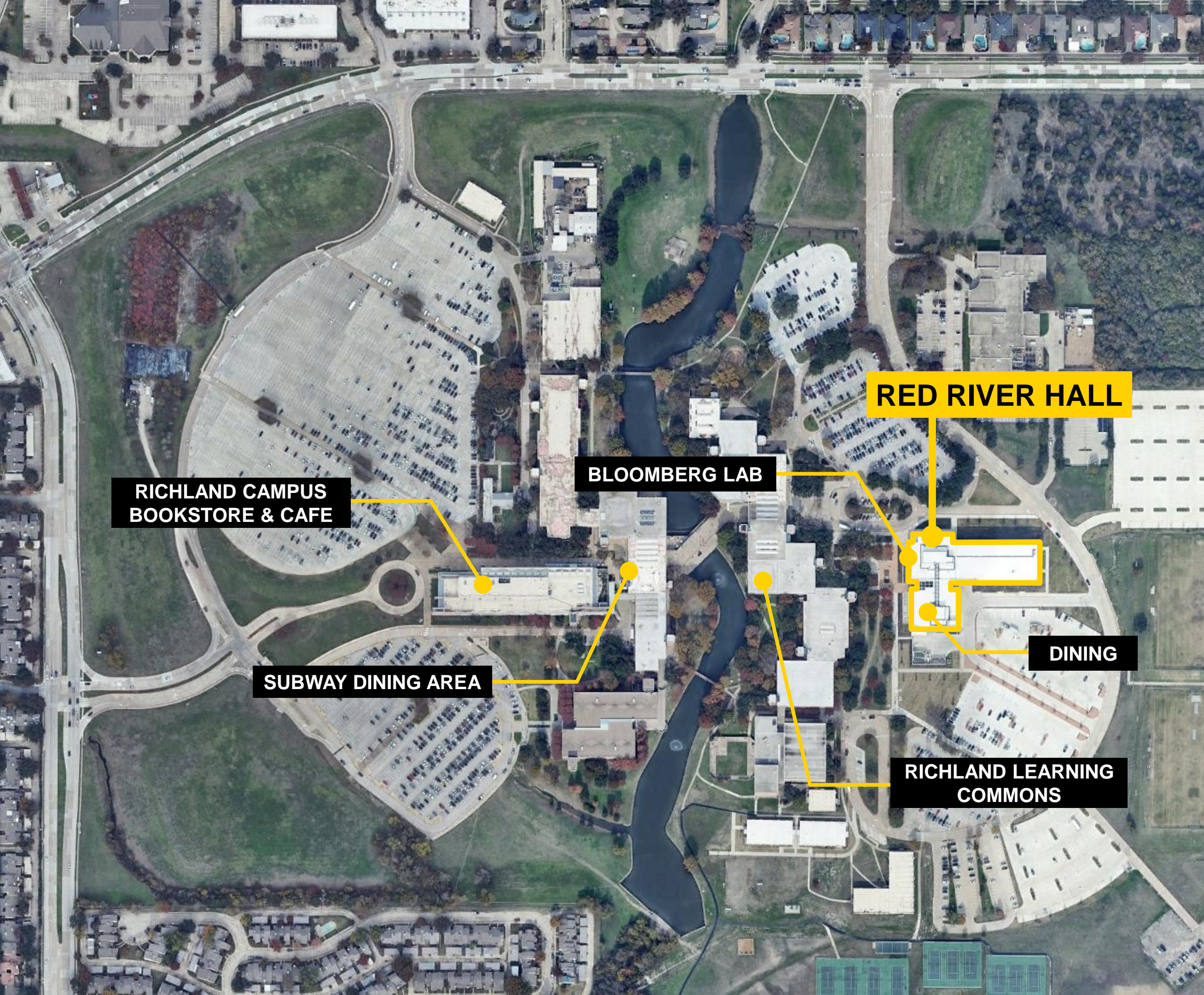



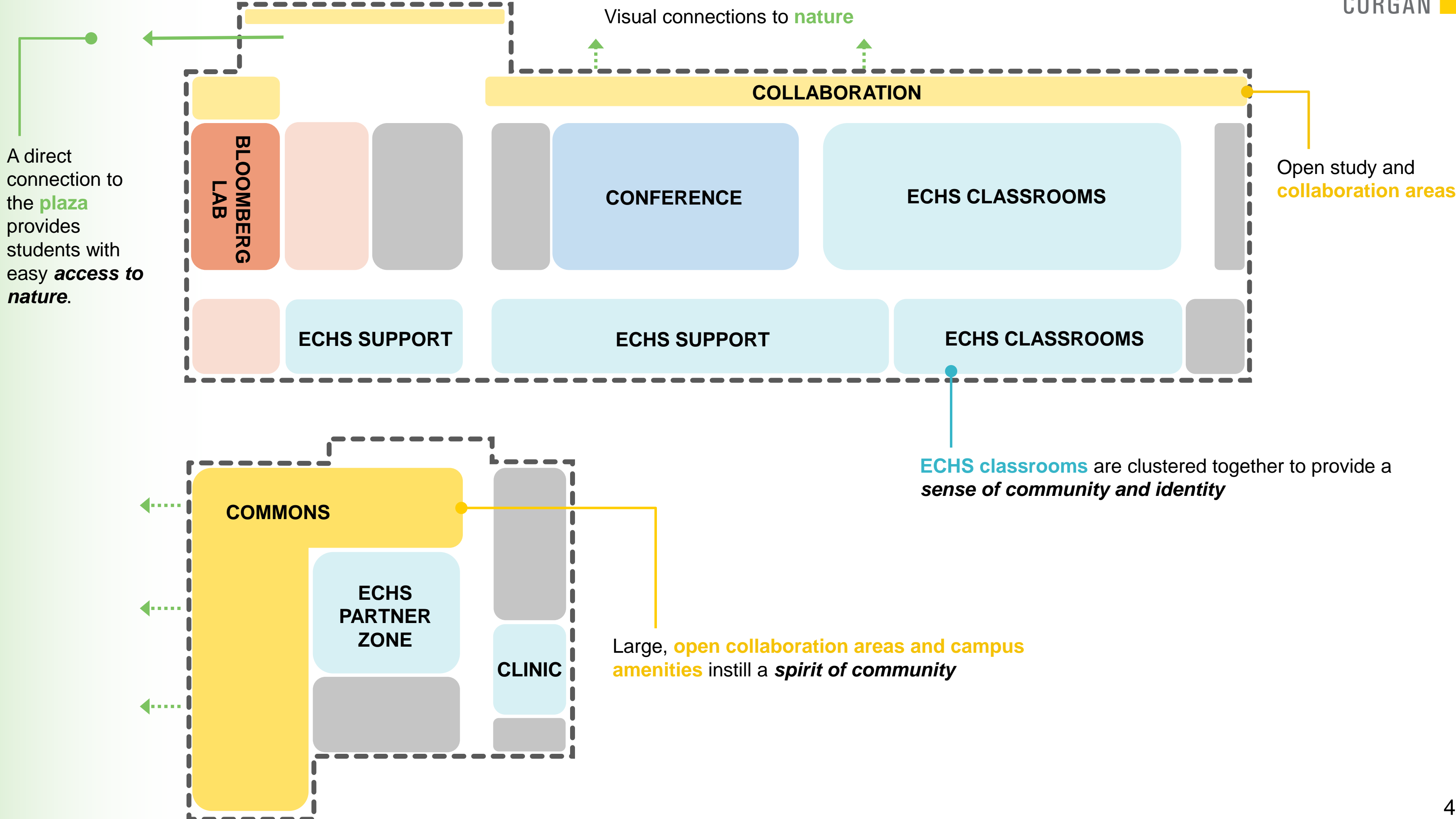



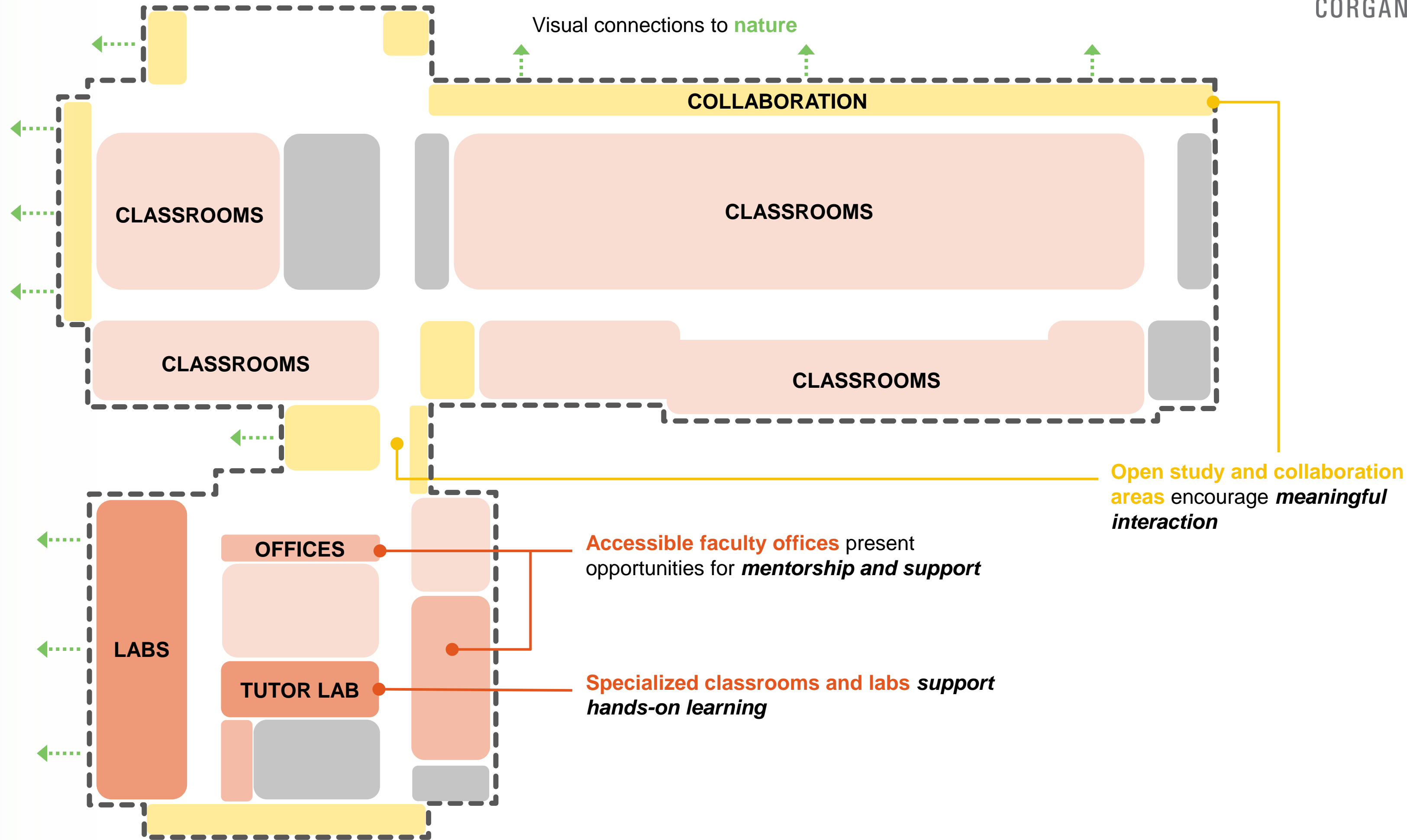





DALLAS  
COLLEGE



## Transformative Facilities: Red River Hall at Dallas College Richland





# Considerations for an ECHS Program on a College Campus



District Partner Offices



Dining



Bus Lane

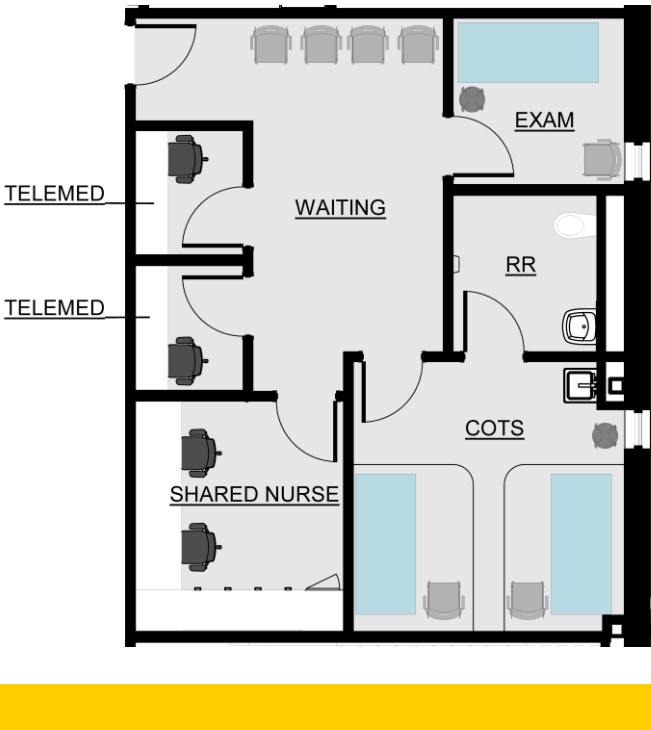

Clinic





PORTAL



RED RIVER HALL

“Portal” to Higher Education



# The Future is Alternative Pathways

1

## **BUILD CONNECTIONS**

Connect students to peers, mentors, local industry opportunities, and real-world learning experiences

2

## **ELEVATED ATMOSPHERE**

Create an innovative, collegiate or professional environment that provides opportunities for both support and independence, building a future-ready mindset

3

## **EDUCATIONAL EXPERIENCE**

The quality of the physical environment impacts educational outcomes

4

## **FUTURE-FOCUSED**

Create a 21st century learning environment that prepares students for *their* future



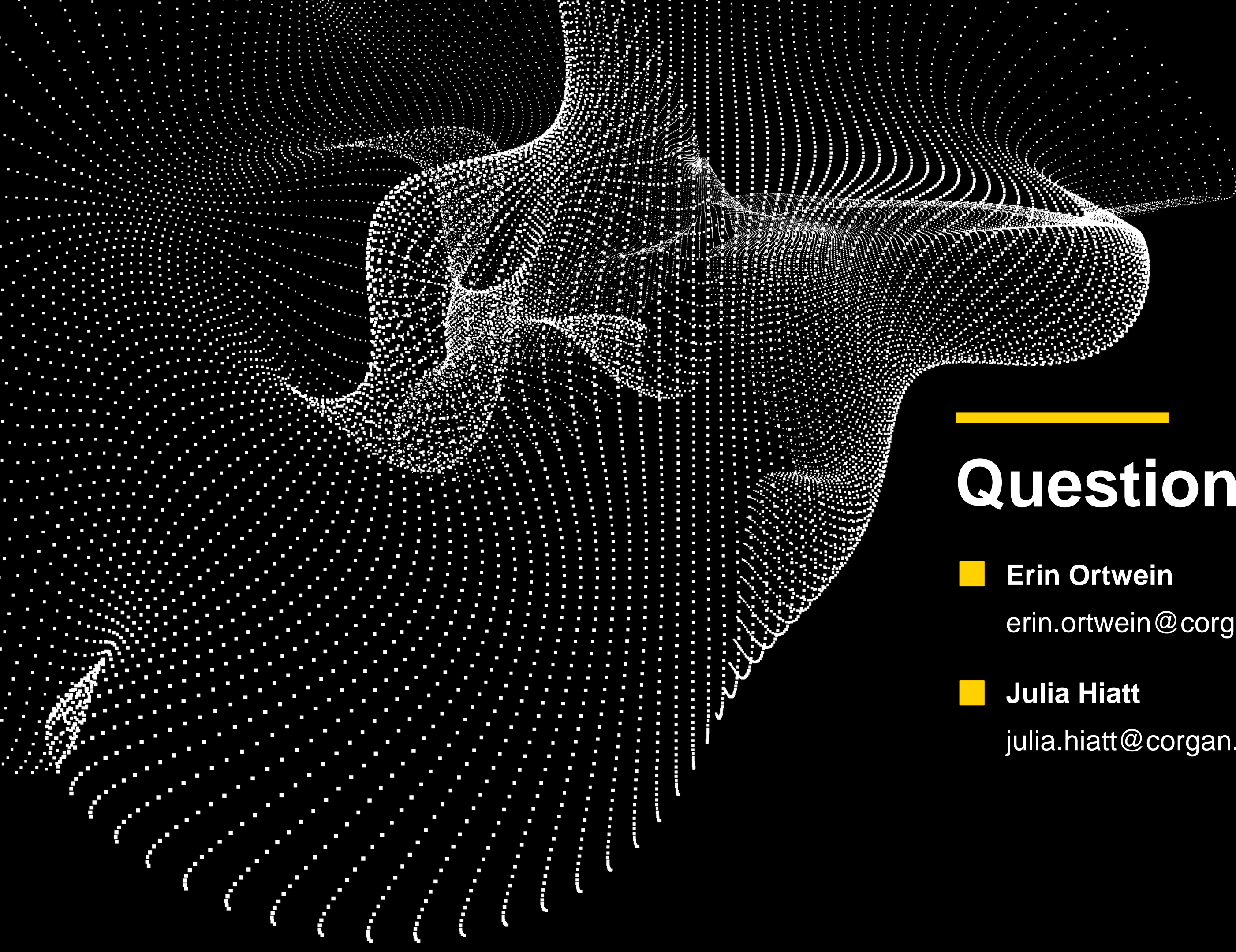

---

# Questions?

■ **Erin Ortwein**  
erin.ortwein@corgan.com

■ **Julia Hiatt**  
julia.hiatt@corgan.com